

PROPOSED BLDG. ADDITION & PARKING FOR:  
**50 S.W. 5TH STREET**  
50 S.W. 5TH STREET POMPANO BEACH, FL 33060  
**Ramos Architects & Associates**  
780 TAMiami CANAL ROAD MIAMI, FL 33144 ■ (305) 506-7388

SEAL:

ARCHITECT OF RECORD  
JOSE RAMOS | FLA. REG. AR11115 | AAC1595

DATE: 07/09/25

PROJECT NUMBER  
**24151**

SHEET  
**LS**

LIFE SAFETY FIXTURE LEGEND

EMERGENCY LIGHT

EXIT SIGN

EXIT / EMERGENCY LIGHT COMBO

DIRECTIONAL EXIT SIGN

E

EXISTING TO REMAIN

N

NEW

EXIT SIGNS MUST BE ELECTRIC WITH BATTERY BACK-UP  
EXIT SIGNS & EMERGENCY LIGHTS WITH BATTERY BACKUP  
RATED FOR 90 MIN.ACCORDING TO THE FLORIDA FIRE PREVENTION CODE  
NFPA 101: SECTION 42 TABLE 42.2.5 AND 42.2.6.

OCCUPANCY INDUSTRIAL:

COMMON PATH..... 50 FEET  
DEAD END..... 50 FEET  
TRAVEL DISTANCE..... 200 FEET

OCCUPANCY BUSINESS:

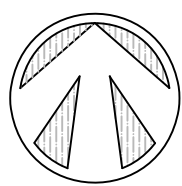
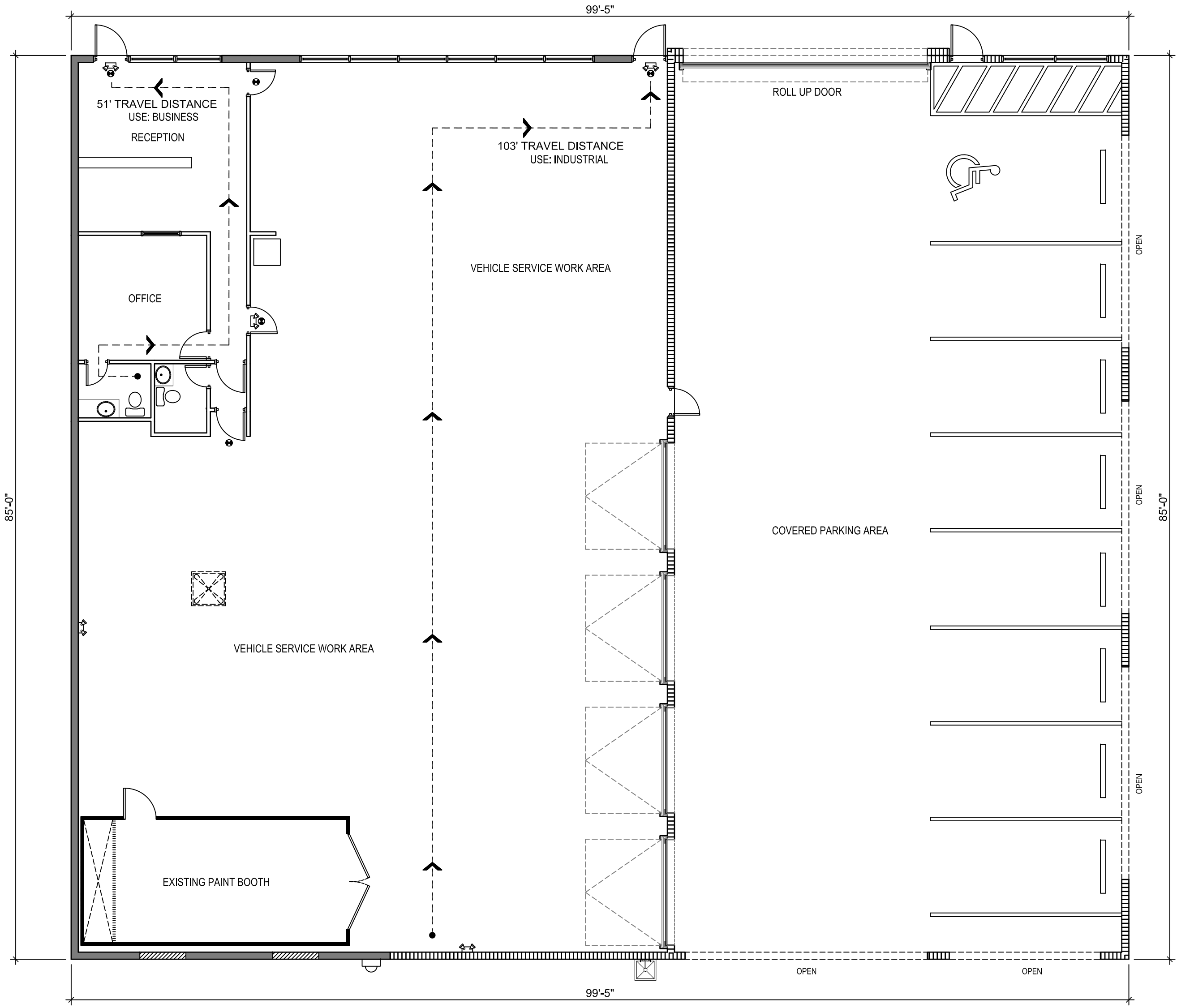
COMMON PATH..... 75 FEET  
DEAD END..... 20 FEET  
TRAVEL DISTANCE..... 100 FEET

PROPOSED LIFE SAFETY PLAN

SCALE: 1/8" = 1'-0"